

Expendable materials

Cons. No.	Designation	Part Number
4	Adhesive: National 5821	002 989 11 71
7	Sealing compound: Dirko Transparent	001 989 29 20

Tightening torques

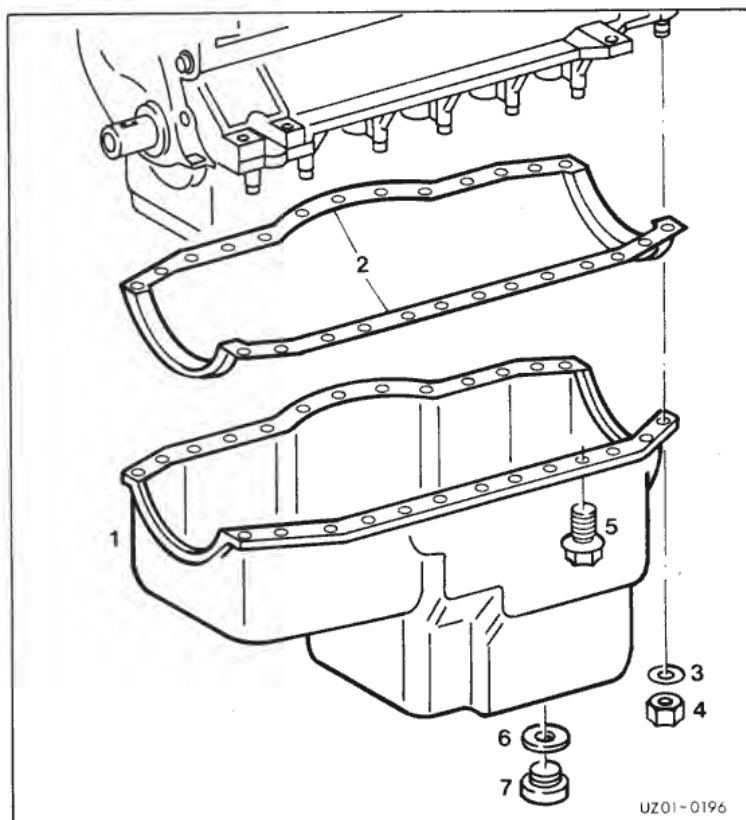

Cons. No.	Designation		Thread	Nm
5	Cast-iron oil pan to crankcase (4 cylinder engines)	- Screw	M 6	12 to 14
		- Bolt	M 8	25
		- Nut to stud	M 8	11 to 13
	Sheet metal oil pan to crankcase (6 cylinder engines)	- Bolt	M 6	8
		- Bolt	M 8	9
		- Nut to stud	M 8	11 to 13
7	Oil drain plug to oil pan		M 26	80 to 90

X1 Removal

18H39 **Note:** Removal and installation is in principle the same for all engine models.

01/53 **1** Remove engine, see 2.1/1 (N 02) or 2.2/1 (D 03).

01/238 **2** Drain engine oil.

01/557 **3** Remove engine oil filter, see 18.2 - 2.1/1 (H 04).

01/241 **6** Detach oil pan.

.T
01.2

9.1/1
9.1/1

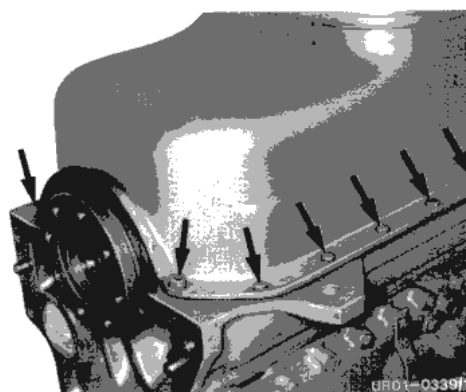

01/025 7 Clean all parts, check, exchange as required.

01H061 **Note:** The sealing surface must be entirely free of oil and grease in the area of the bearing covers on the crankcase, front and rear.

X2 **Installation**

01H062 **Note:** To facilitate the illustration, the flywheel housing has been detached in the photo.

01/1403 1 Apply sealing compound no. 7 in the four corners on the bearing cover facing the crankcase.

01/1404 2 Coat gasket with adhesive no. 4 and mount on the crankcase and press on until it lies with full contact in the groove of the bearing cover.

01H252 **Caution!**
Only use complete gasket sets in accordance with the valid spare parts documents. As a spare part only the one-piece gasket is available.

01/1407 3 The further installation takes place in the same manner in reverse sequence, in this connection observe the following:

01/1383 – Observe permissible tightening torques.

