

Sectional view

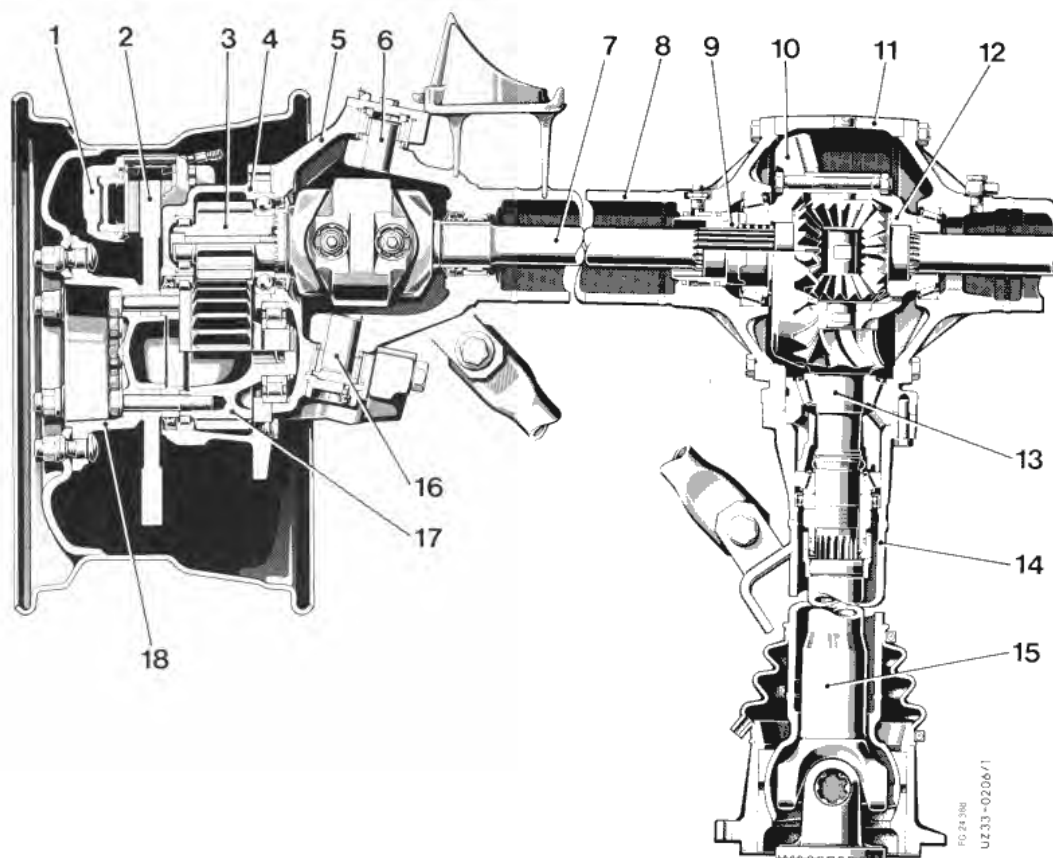

AU 2/13 CS – 4,4

- | | | | |
|---|--------------------|----|---------------------|
| 1 | Fixed caliper | 10 | Ring gear |
| 2 | Brake disc | 11 | Axle center housing |
| 3 | Drive gear | 12 | Differential |
| 4 | Wheel hub drive | 13 | Drive pinion |
| 5 | Steering knuckle | 14 | Torque tube |
| 6 | Kingpin, top | 15 | Input shaft |
| 7 | Double joint shaft | 16 | Kingpin, bottom |
| 8 | Axle tube | 17 | Output gear |
| 9 | Differential lock | 18 | Wheel hub |

.T
33.12

1.3/1
1. 311

Sectional view

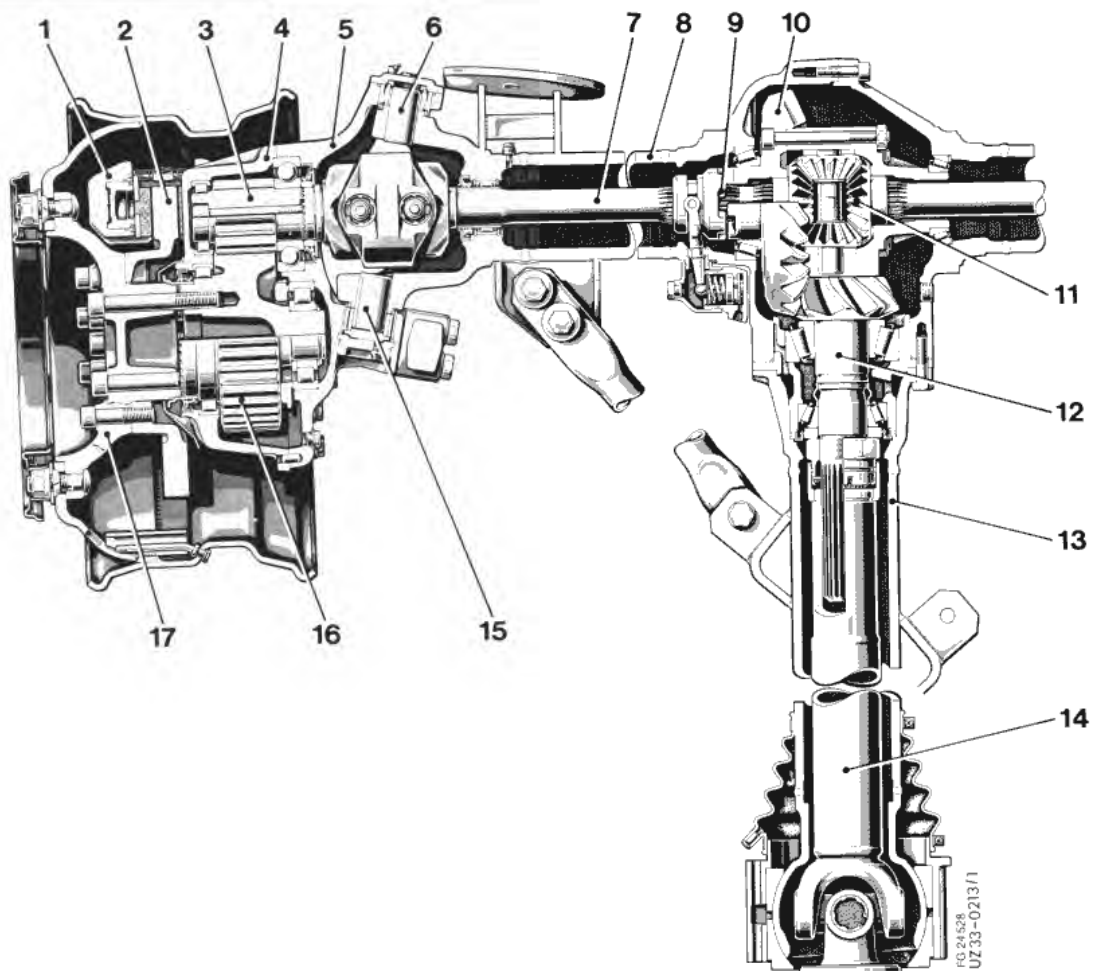

AU 3/2 CS – 7,0

- | | | | |
|---|--------------------|----|-----------------|
| 1 | Fixed caliper | 10 | Ring gear |
| 2 | Brake disc | 11 | Differential |
| 3 | Drive gear | 12 | Drive pinion |
| 4 | Wheel hub drive | 13 | Torque tube |
| 5 | Steering knuckle | 14 | Propeller shaft |
| 6 | Kingpin, top | 15 | Kingpin, bottom |
| 7 | Double joint shaft | 16 | Output gear |
| 8 | Axle tube | 17 | Wheel hub |
| 9 | Differential lock | | |

.T
33.12

1.3/2
1.3/2

Sectional view

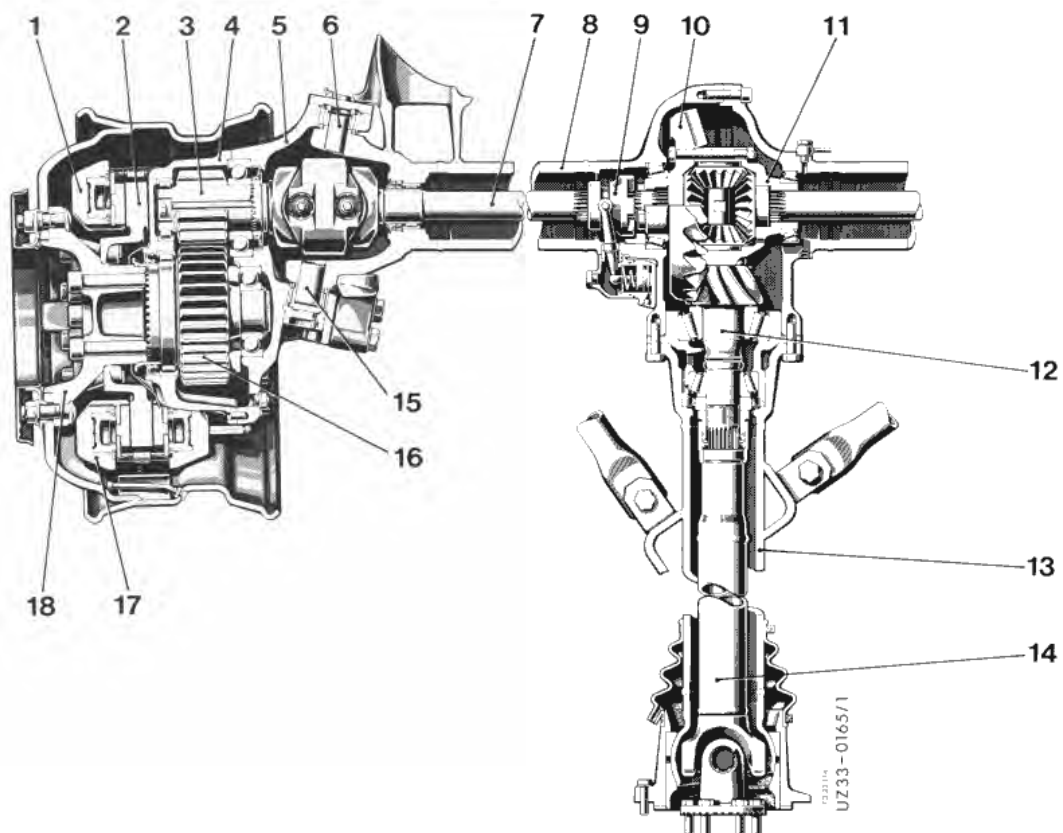

AU 3/1 CS – 6,0

- | | | | |
|---|--------------------|----|-----------------|
| 1 | Fixed caliper | 10 | Ring gear |
| 2 | Brake disc | 11 | Differential |
| 3 | Drive gear | 12 | Drive pinion |
| 4 | Wheel hub drive | 13 | Torque tube |
| 5 | Steering knuckle | 14 | Propeller shaft |
| 6 | Kingpin, top | 15 | Kingpin, bottom |
| 7 | Double joint shaft | 16 | Output gear |
| 8 | Axle tube | 17 | Fixed caliper |
| 9 | Differential lock | 18 | Wheel hub |

.T
33.12

1.3/3
1.313

Sectional view

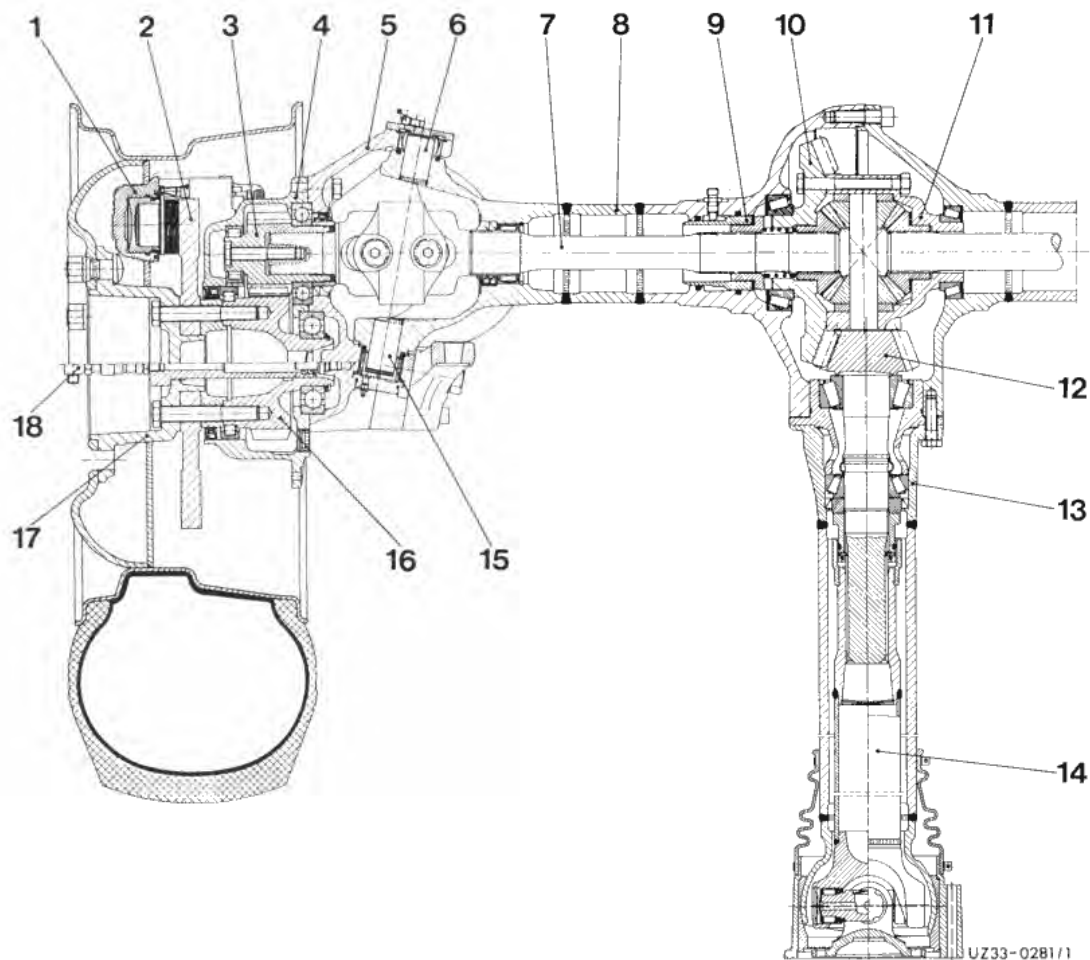
**AU 2/15 CS – 3,0**

- | | | | |
|---|--------------------|----|-------------------------------|
| 1 | Fixed caliper | 10 | Ring gear |
| 2 | Brake disc | 11 | Differential |
| 3 | Drive gear | 12 | Drive pinion |
| 4 | Wheel hub drive | 13 | Torque tube |
| 5 | Steering knuckle | 14 | Propeller shaft |
| 6 | Kingpin, top | 15 | Kingpin, bottom |
| 7 | Double joint shaft | 16 | Output gear |
| 8 | Axle tube | 17 | Wheel hub |
| 9 | Differential lock | 18 | Connection, tire control (SA) |

Sectional view

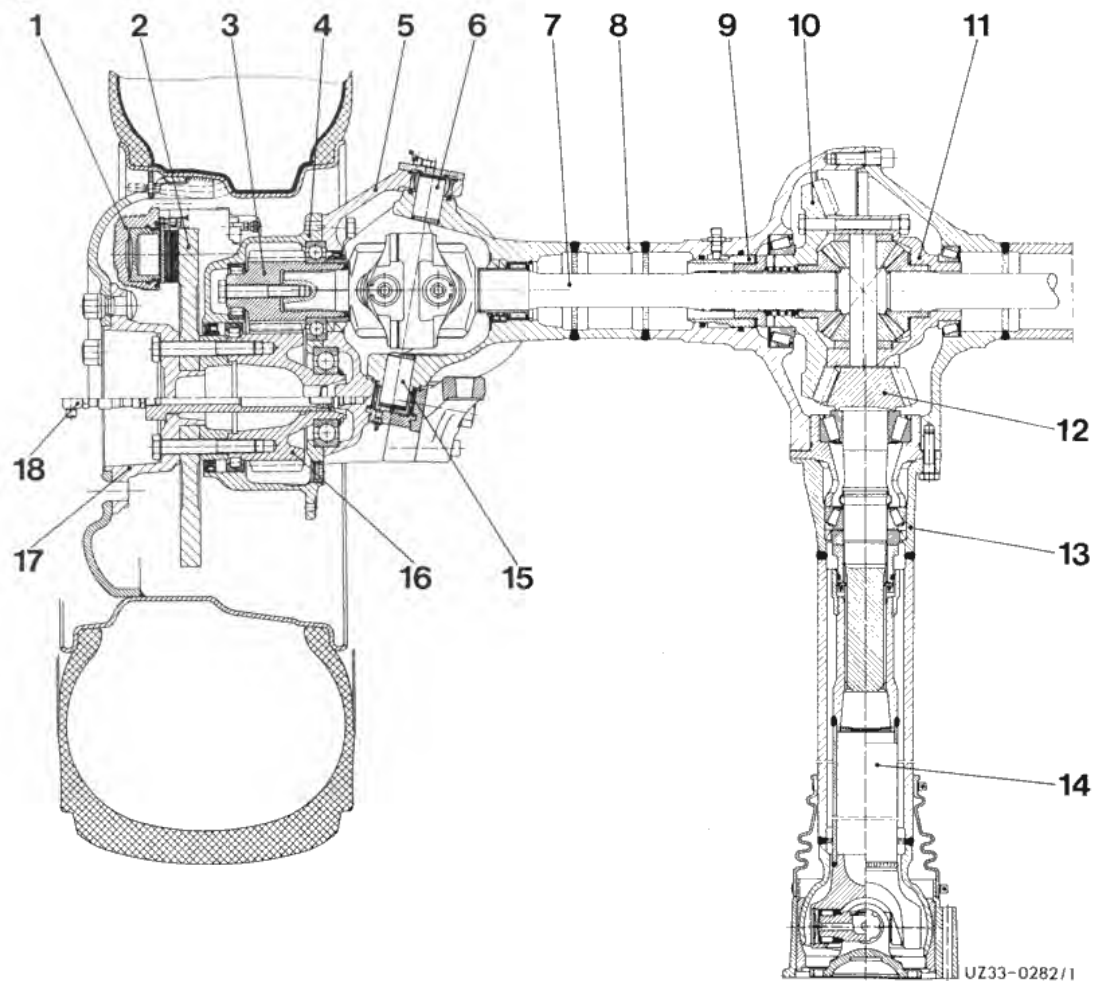

UZ33-0282/1

AU 2/16 CS – 4,0

- | | | | |
|---|--------------------|----|-------------------------------|
| 1 | Fixed caliper | 10 | Ring gear |
| 2 | Brake disc | 11 | Differential |
| 3 | Drive gear | 12 | Drive pinion |
| 4 | Wheel hub drive | 13 | Torque tube |
| 5 | Steering knuckle | 14 | Propeller shaft |
| 6 | Kingpin, top | 15 | Kingpin, bottom |
| 7 | Double joint shaft | 16 | Output gear |
| 8 | Axle tube | 17 | Wheel hub |
| 9 | Differential lock | 18 | Connection, tire control (SA) |